



THE PROPERTY
EXPLORER



4 John Hunt Drive, Basingstoke, Hants, RG24 9TX
£1,220 PCM





4 John Hunt Drive, Basingstoke, Hants, RG24 9TX

£1,220 PCM

AVAILABLE IMMEDIATELY..... Explorer Lettings are pleased to offer this Modern ground floor apartment located in the popular Everest Park development. Further benefits Two double bedrooms, En-suite to master, family bathroom, open plan Lounge/kitchen/diner, hard flooring throughout and comes with one allocated parking space. Council tax band C. Regret no pets, No smoking. Unfurnished

Tenant Information: Assuming rent agreed at £1,220 per month the Holding Deposit £281.53 is payable once offer accepted 'Subject to contract' to go towards first months rent and 5 x weeks Security Deposit £1,407.69 + Remaining First months rent £938.47 payable 2 working days before check in.

NB. Applicants must earn min 30 x rental (£1,220 pcm x 30) = £36,600 per year

- TWO DOUBLE BEDROOMS
- GROUND FLOOR
- EN-SUITE TO MASTER BEDROOM
- OPEN PLAN LOUNGE/KITCHEN
- ALLOCATED PARKING SPACE
- UNFURNISHED
- AVAILABLE IMMEDIATELY



Unfurnished

Council Tax Band: C

Available: 13th April 2026

Deposit: £1,407

Floor Plans

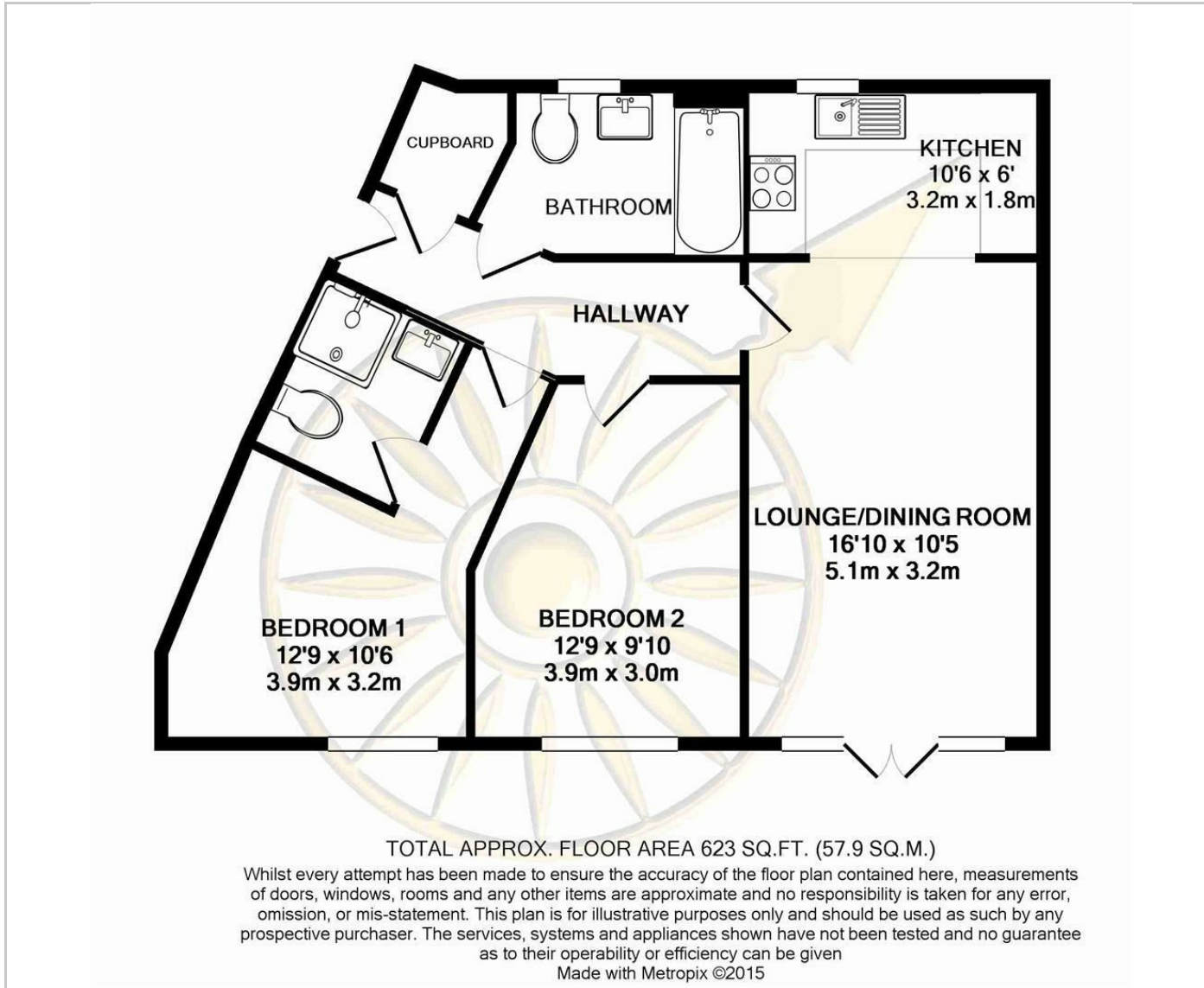

Area Map

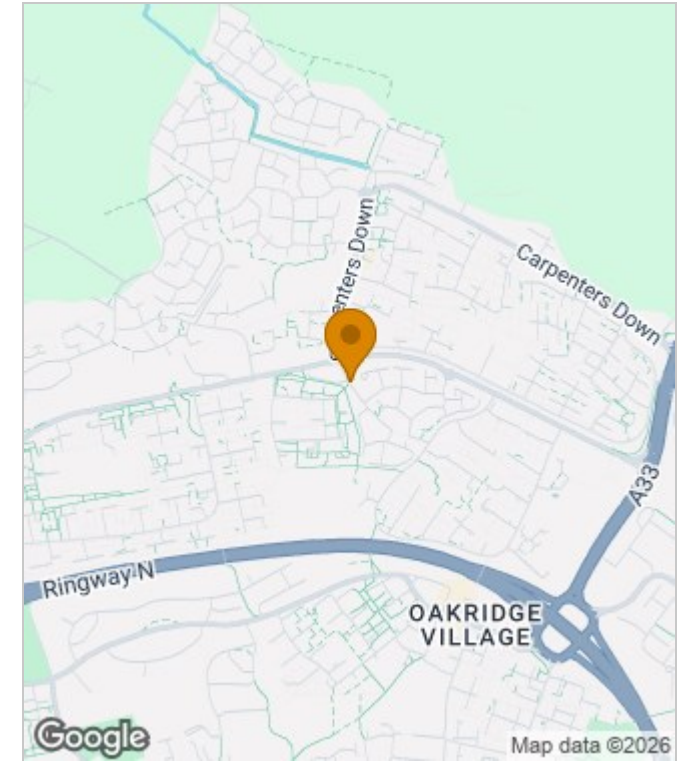

Energy Performance Graph

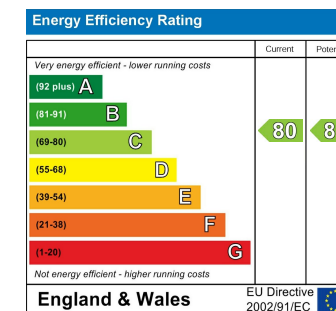

These particulars, whilst believed to be accurate are set out as a general outline only for guidance and do not constitute any part of an offer or contract. Intending purchasers should not rely on them as statements of representation of fact, but must satisfy themselves by inspection or otherwise as to their accuracy. No person in this firm's employment has the authority to make or give any representation or warranty in respect of the property.